

Revision date:
03.09.2016

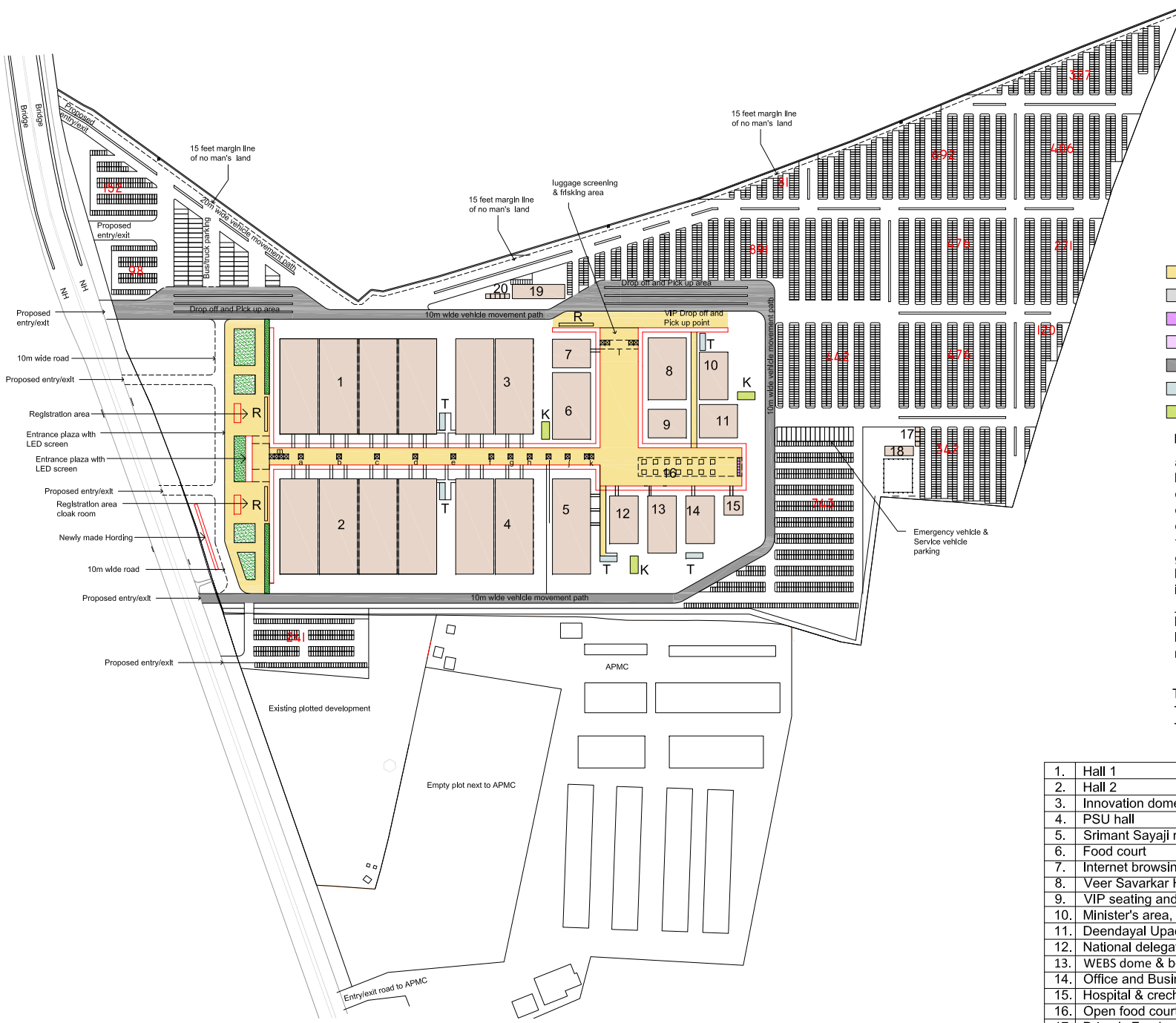

- Paver area
- Proposed Road
- Outdoor food court stall
- Outdoor food seating
- Road area
- Toilet
- Kitchen

- R Registration
- a - Cloak room and tours & travel desk
- b - Florist shop
- c - Local sim counter
- d - Refreshment lounge
- e - Security office
- f - Lost and found counter
- g - Travel and tourism desk
- h - Florist shop
- i - ATM
- j - Refreshment lounge
- k - Interpreter desk & Garba Passes desk
- l - take away bags counter
- m - take away bags counter

Total car parking bays : 5758 nos
Total Bus parking bays : 48nos
Total Emergency vehicle parking bays : 16nos

1.	Hall 1	160 x 100 m
2.	Hall 2	160 x 100 m
3.	Innovation dome	80 x 100 m
4.	PSU hall	80 x 100 m
5.	Srimant Sayaji rao Gaekward Convention Centre	40 x 100 m
6.	Food court	40 x 70 m
7.	Internet browsing center and Media center	30 x 40 m
8.	Veer Savarkar Hall - 300 pax	40 x 65 m
9.	VIP seating and dining area	30 x 40 m
10.	Minister's area, Seating and dining area	30 x 50 m
11.	Deendayal Upadhaya Hall 600 pax	40 x 35 m
12.	National delegate dining	30 x 50 m
13.	WEBS dome & board rooms (3nos)	30 x 60 m
14.	Office and Business center	30 x 50 m
15.	Hospital & creche	20 x 20 m
16.	Open food court	20 x 100 m
17.	Driver's Food center	10x 30m
18.	Driver's lounge	5 x 5 m x 4nos
19.	Fair facility	15 x 55 m
20.	Cargo office	5 x 5 m x 5nos

MASTER PLAN

PAVILION - 1

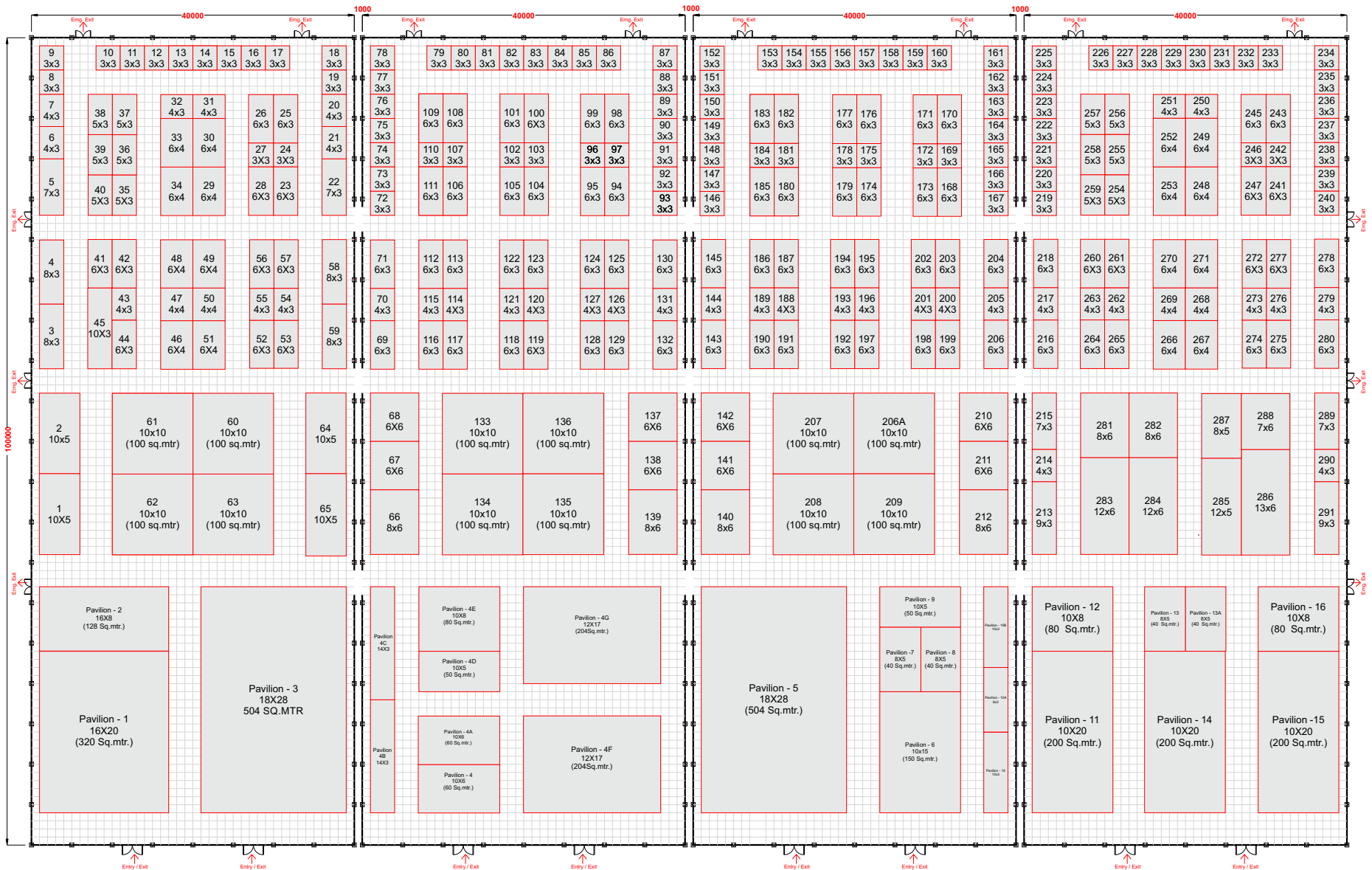

PAVILION - 2

